

Project Name:	Fixture Type:
Complete Catalog #:	Date:
Comments:	

WESTMINSTER MULTI WATTAGE & CCT SELECTABLE POST TOP FIXTURE



The **Westminster Multi Wattage & CCT Selectable Post Top Fixture** has a decorative design and the latest LED technology. The housing is durable ADC12 die-cast aluminum with an acrylic diffuser (polycarbonate diffuser optional). This post top is IP65 rated for outdoor applications and is ideal for sidewalks, parks, roadways, and site area lighting. The post top is offered in two sets of three lumen packages (30W/50W/60W and 60W/80W/100W); as well as 3-CCT selectable (3000K/4000K/5000K). The Westminster is UL and DLC listed.

FEATURES

- UL wet location
- DLC
- 3-wattage & 3-CCT selectable
- Up to 110 lm/W
- IP65
- 120-277VAC or 277-480VAC
- Up to 11,000 lumens
- Button photocell sensor option

APPLICATIONS

- Sidewalks
- Parks
- Roadways
- Gardens
- Site area lighting



ORDERING INFORMATION

PART NUMBER	SELECTABLE WATTAGE	MAXIMUM SELECTABLE LUMENS	VOLTAGE	SELECTABLE CCT	MIN. ORDER QUANTITY	US STOCK
ECO-CH-YTPG-MW(30/50/60W)MCCY(30/40/50K)	30W/50W/60W	6,600	120-277VAC or 277-480VAC	3000K/4000K/5000K	2	Yes
ECO-CH-YTPG-MW(60/80/100W)MCCY(30/40/50K)	60W/80W/100W	11,000	120-277VAC or 277-480VAC	3000K/4000K/5000K	2	Yes

TECHNICAL SPECIFICATIONS

Light Distribution	Type V
Selectable CCT	3000K/4000K/5000K
Selectable Wattage	30W/50W/60W or 60W/80W/100W
Max Selectable Lumens	6,600 lumens or 11,000 lumens
Efficacy	110 Lm/W
IP Rating	IP65
Input Voltage	120-277VAC or 277-480VAC
Power Frequency	50-60 Hz
Total Harmonic Distortion (THD)	<20%
Certifications	UL wet listed, DLC, FCC
Housing Material	Die-cast Aluminum with acrylic diffuser (PC diffuser optional)
Rated Life (L70)	>50,000 Hours
Warranty	10 Years, 50,000 Hours Non-Prorated
Operating Temperature	-40°F to 113°F
Controls	3-Wattage selectable, 3-CCT selectable, Optional button photocell sensor.
Net Weight	13.67 lbs

*Data is based upon tests performed in a controlled environment and representative performance. Actual performance can vary depending on operating conditions. Specifications are subject to change without notice. All specifications are nominal unless otherwise noted.

*IES files provided on request.

WESTMINSTER MULTI WATTAGE & CCT SELECTABLE POST TOP FIXTURE

CONTROLS

Control Options: 3-Wattage selectable, 3-CCT selectable, and optional button photocell sensor.

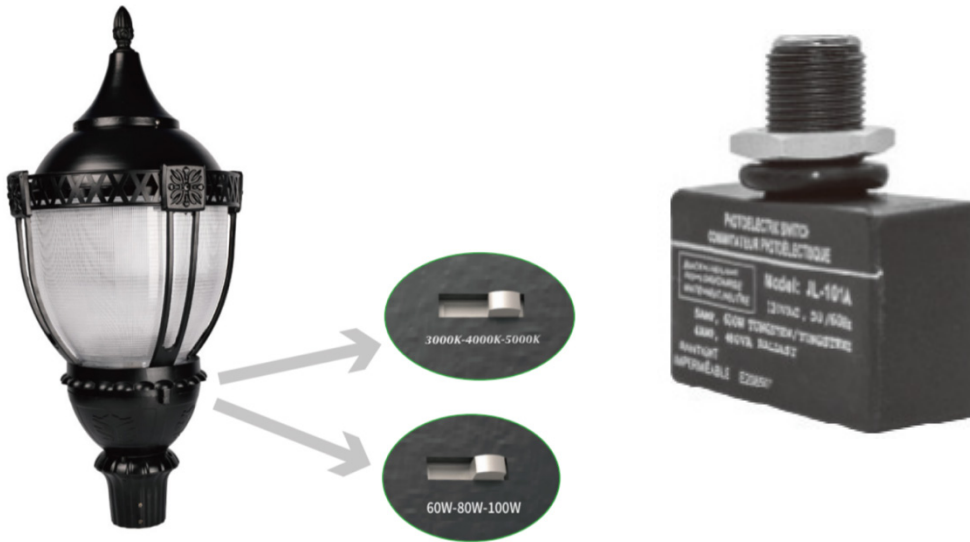

MOUNTING OPTIONS

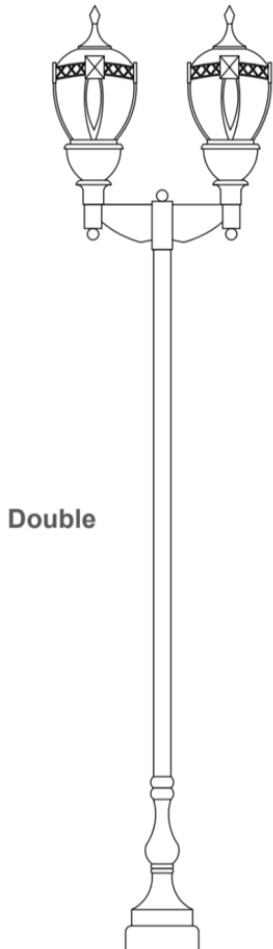

WESTMINSTER MULTI WATTAGE & CCT SELECTABLE POST TOP FIXTURE

DIMENSIONS

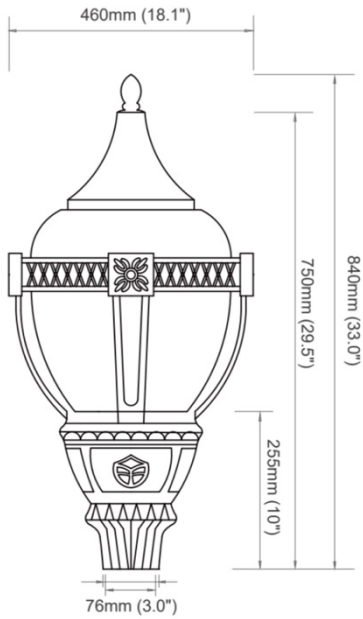

PHOTOMETRICS

